

THIS COPY IS PROVIDED ON A RESTRICTED BASIS AND IS NOT TO BE USED IN ANY WAY DETRIMENTAL TO THE INTERESTS OF PANDUIT CORP.

PANDUIT PART NUMBER*	NO. OF BUNDLES	'A'	REC. FAST.	'B'	'C' ±.062	'D' ±.015	'E'	'F' REF	'G'	'H'	USE WITH CABLE TIE	WEIGHT lbs (g) / 100 pcs.
MTPC1H-E10	1	0.205	#10 SCR.	0.305	2.094	0.625	0.203	1.50	.320	.103	M, I, S, H	0.72 [324]
MTPC2H-E10	2				3.594			3.00				1.20 [543]
MTPC3H-E10	3				5.094			4.50				1.69 [766]
MTPC4H-E10	4				6.594			6.00				2.4 [1089]
MTPC5H-E10	5				8.094			7.50				2.9 [1315]
MTPC6H-E10	6				9.594			9.00				3.4 [1542]
MTPC7H-E10	7				11.094			10.50				3.7 [1672]

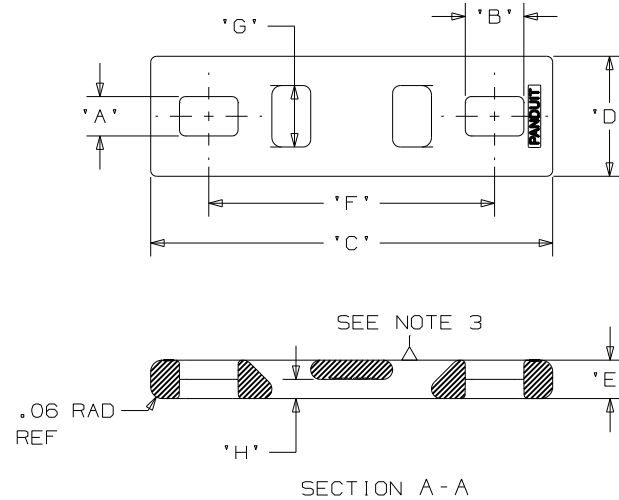

NOTES:

- SEE CURRENT PRICE SHEET FOR PART NUMBER SUFFIX DESIGNATION FOR PACKAGE SIZE.
- MATERIAL:
-39: NATURAL HEAT STABILIZED NYLON 6/6
- KNOCKOUT PIN WITNESS SHALL BE FLUSH TO -.002
- ENGRAVING PLACED ON THE TOP SURFACE ('PANDUIT', AS SHOWN) SHALL BE LOCATED ON THE ENDS OF THE PART RECESSED BELOW SURFACE.

DIMENSIONS IN BRACKETS ARE METRIC [mm]	
CAD FILENAME/LAYERS G00239MY_DC_GB0239MY/OOB	
MTP CONTOUR SERIES MULTIPLE TIE PLATE	
UNLESS OTHERWISE SPECIFIED, DIMENSIONAL TOLERANCES ARE: (.X) ±0.05 [1.3] (.XXX) ±0.010 [0.25] (.XX) ±0.02 [0.5] ANGLES ± 5°	UNLESS OTHERWISE SPECIFIED, ALL DIMENSIONS ARE GIVEN IN INCHES, THIRD ANGLE PROJECTION.
OOB 7/8/08 ARHA R 4/10/07 DJSM REV DATE BY CHK	DRAWN BY DJSM DATE 4/10/07 CHK'D MAT'L: SEE NOTE 2 SCALE NONE DRAWING NO. GB0239MY DWG SIZE A

REV	DATE	BY	CHK	DESCRIPTION	ECN	R	CUST	SUP
OOB	7/8/08	ARHA		ADDED MTPC7H-E10, REMOVED -30 MATERIAL, REV'D TO TEAMCENTER NAME AND REV HISTORY	GB0239MY	OOB		
R	4/10/07	DJSM		INITIAL RELEASE - REPLACES GB0239MS	GB0239MY	R		